

### Symbol

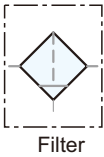

### Features

1. Remove water and particle effectively.
2. 40μm and 5μm filter element are easily interchangeable and replaceable.

### How to order

UF – 02	N	C	H	B	A	
Filter	Port size	Thread	Filtration	Drain	Mounting	Bowl
	02 : 1/4"	Blank : G	PE	Blank : Semi-auto drain	Blank : W/O bracket	Blank : Standard bowl
	03 : 3/8"	N : NPT	Blank : 5μm	H : Manual drain	B : W/I bracket	A : Anti-acid & alkali bowl
	04 : 1/2"	R : Rc	C : 40μm	D : Auto drain		AL : Aluminum bowl (1/4"~1/2")
	06 : 3/4"		Sintered brass			
	08 : 1"		S : 5μm			
			T : 40μm			

### Specifications

Model	UF-02	UF-03	UF-04	UF-06	UF-08
Port size	1/4"	3/8"	1/2"	3/4"	1"
Fluid	Compressed air				
Body material	Aluminum die-cast				
Bowl material	Polycarbonate (Standard), Anti-acid & alkali bowl (Option), Aluminum bowl (Option)				
Filtration	PE: 5μm (Standard), 40μm (Option); Sintered brass(Option):5μm, 40μm				
Operating pressure range	0.5 ~ 9.9 kgf/cm²				
Proof pressure (Standard bowl)	15 kgf/cm²				
Max. flow rate l/min (ANR)	2440	2450	3030	8250	8860
Ambient temperature	-10℃ ~ 60℃				
Filter bowl capacity	105cc			210cc	
Standard drain	Semi-auto drain (Drains below 0.5kgf/cm²)				
Net weight	530g (W/I Aluminum bowl 830g)			1250g	
Option	Mounting bracket set				

### Flow chart

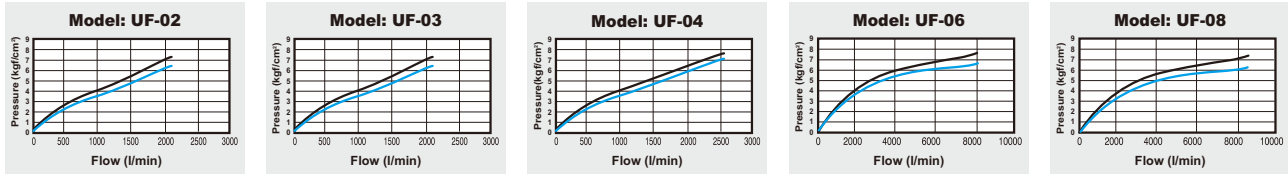

**Note:** X axis: Flow (l/min), Y axis: Pressure (kgf/cm<sup>2</sup>), Blue line (P0) = Outlet pressure, Black line (P1) = Inlet pressure, P1-P0= Pressure range

### Dimensions

#### UF-02, 03, 04

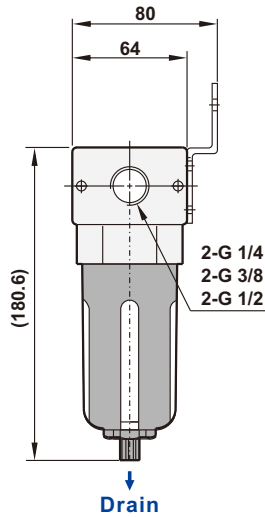
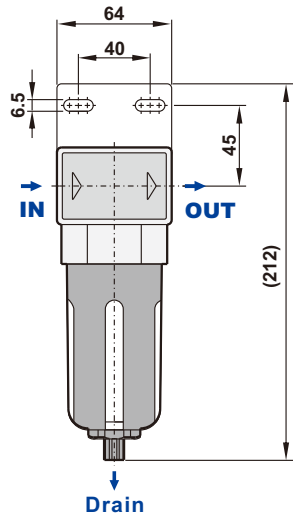

#### UF-02AL, 03AL, 04AL (Aluminum bowl)

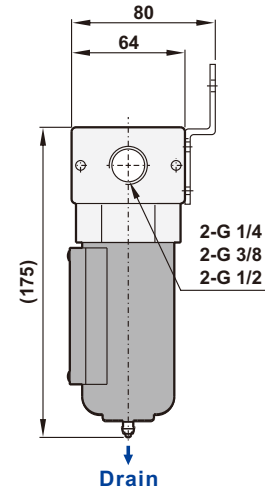
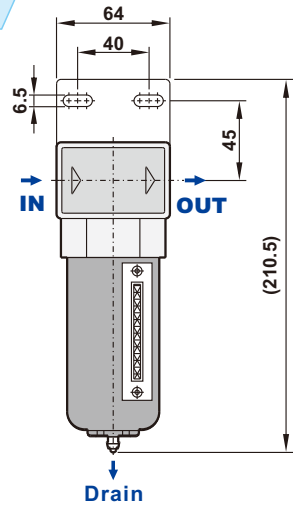

#### UF-06, 08

