

## Symbol

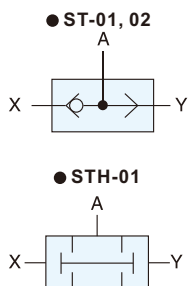

## Features

### Shuttle valve

1. Check ball moves from high pressure inlet to low pressure inlet.
2. The valve provides two inlets for air supply.
3. Available port sizes G1/8", 1/4".

### Double pressure valve

1. The valve provides X and Y inlet for double pressure supply.



## How to order

ST	—	01	N
ST : Shuttle valve		Port size	Thread
STH : Double pressure valve		01 : 1/8" 02 : 1/4"	Blank: G N : NPT R : Rc

## Specifications

Model	ST-01	ST-02	STH-01
Port size	1/8"	1/4"	1/8"
Body material	Aluminum alloy		
Fluid	Compressed air		
Sectional area	7.5mm <sup>2</sup>	21mm <sup>2</sup>	14mm <sup>2</sup>
Operating pressure range	1 ~ 9.9 kgf/cm <sup>2</sup>		
Proof pressure	10 kgf/cm <sup>2</sup>		
Ambient temperature	-10°C ~ 80°C		
Max. flow rate (l/min)	823	1583	857

## Dimensions

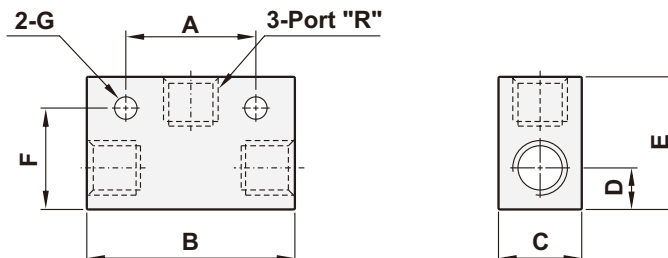

Model	R	A	B	C	D	E	F	G
STH-01	1/8"	25	40	16	8	25.4	19.4	φ 4.3
ST-01	1/8"	25	40	16	8	25.4	19.5	φ 4.3
ST-02	1/4"	35	52	22	11	35	25	φ 5.5