

Symbol

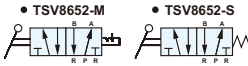

Features

1. Easy operation.
2. Large flow rate.
3. Suitable for vacuum operation.
4. Available for panel mounting.
5. Mounting bracket as optional accessory.
6. TSV8652R-01/02 for manifold assembly.



How to order

TSV8652	R	—	02	N	M	F
5/2 Way	Manifold		Port size	Thread	Acting	Mounting bracket
	Blank : Standard R : Manifold type (for 1/8", 1/4" port only)		01 : 1/8" 02 : 1/4" 03 : 3/8" 04 : 1/2"	Blank : G N : NPT R : Rc	S : Spring return M : Detent	Blank : W/O bracket F : W/I mounting bracket (For 1/8", 1/4" port only)

Specifications

Model	TSV8652(R)-01M(S)	TSV8652(R)-02M(S)	TSV8652-03M(S)	TSV8652-04M(S)
Port size	1/8"	1/4"	3/8"	1/2"
Body material	Aluminum alloy			
Fluid	Compressed air			
Sectional area	14mm ²	18mm ²	35mm ²	38mm ²
Operating pressure range	0 ~ 9 kgf/cm ²			
Proof pressure	10 kgf/cm ²			
Ambient temperature	-10℃ ~ 60℃			

Dimensions

TSV8652-01,02M(S)

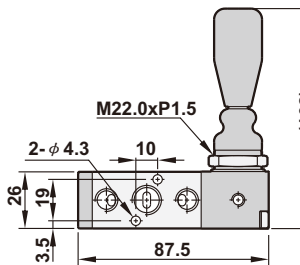
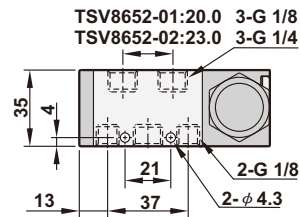

TSV8652-03M(S)

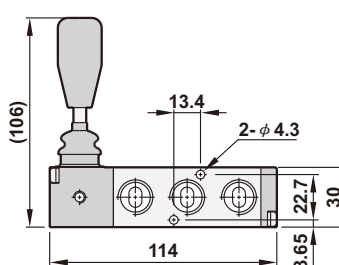
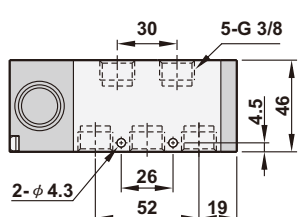

TSV8652-04M(S)

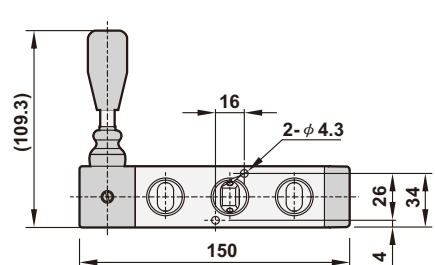
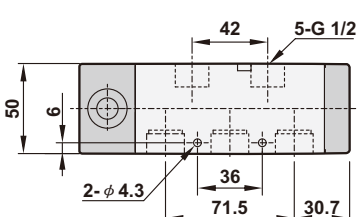

Dimensions

TSV8652R-01,02

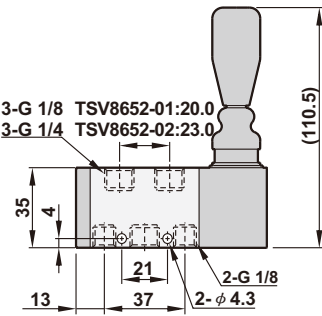
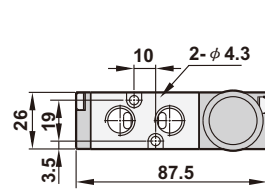

TSV8652-01,02MF

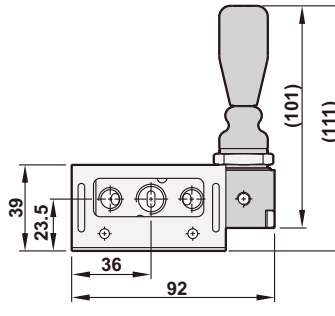
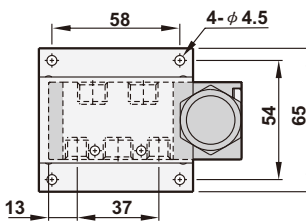

MF520-0202

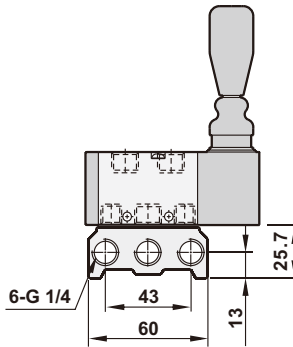
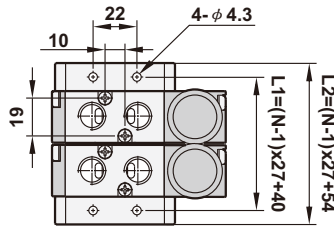

Number of station (N)	2	3	4	5	6	7	8	9	10
L1	67	94	121	148	175	202	229	256	283
L2	81	108	135	162	189	216	243	270	297

Explosion

